

SPECIFICATION

Caps

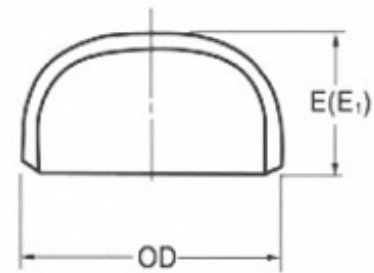

ASME/ANSI B16.9

Nominal Pipe Size		Outside Diameter at Bevel, OD	Length, E	Length, E	Limiting Wall Thickness for Length, E
DN	NPS				
15	1/2"	21.3	25	25	4.57
20	3/4"	26.7	25	25	3.81
25	1"	33.4	38	38	4.57
32	1-1/4"	42.2	38	38	4.83
40	1-1/2"	48.3	38	38	5.08
50	2"	60.3	38	44	5.59
65	2-1/2"	73	38	51	7.11
80	3"	88.9	51	64	7.62
90	3-1/2"	101.6	64	76	8.13
100	4"	114.3	64	76	8.64
125	5"	141.3	76	89	9.65
150	6"	168.3	89	102	10.92
200	8"	219.1	102	127	12.7
250	10"	273	127	152	12.7
300	12"	323.8	152	178	12.7
350	14"	355.6	165	191	12.7
400	16"	406.4	178	203	12.7
450	18"	457	203	229	12.7
500	20"	508	229	254	12.7
550	22"	559	254	254	12.7
600	24"	610	267	305	12.7
650	26"	660	267		

SPECIFICATION

Caps

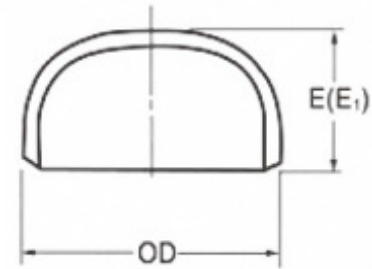

ASME/ANSI B16.9

Nominal Pipe Size		Outside Diameter at Bevel, OD	Length, E	Length, E	Limiting Wall Thickness for Length, E
DN	NPS				
700	28"	711	267		
750	30"	762	267		
800	32"	813	267		
850	34"	864	267		
900	36"	914	267		
950	38"	965	305		
1000	40"	1016	305		
1050	42"	1067	305		
1100	44"	1118	343		
1150	46"	1168	343		
1200	48"	1219	343		

Note:

- All dimensions are in millimeters
- The shape of these caps are ellipsoidal
- Length E applies for thickness not exceeding that given in column "Limiting Wall Thickness for Length, E."
- Length E, applies for thickness greater than that given in column "Limiting Wall Thickness" for NPS 24 and smaller. For NPS 26 and larger, Length E, shall be by agreement between the manufacturer and purchaser.