

SPECIFICATION

**Short Radius Elbows(45° 90°)**

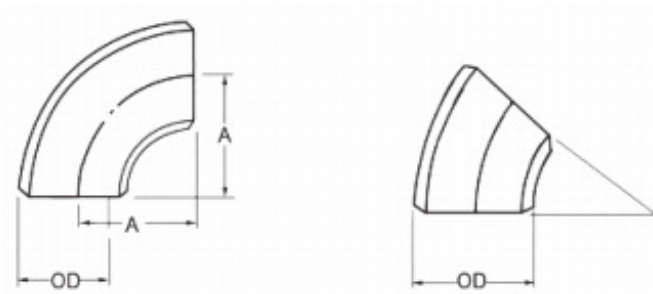

ASME/ANSI B16.28

Nominal Pipe Size		Outside Diameter at Bevel, OD	Center-to-End
DN	NPS		A
25	1"	33.4	25
32	1-1/4"	42.2	32
40	1-1/2"	48.3	38
50	2"	60.3	51
65	2-1/2"	73	64
80	3"	88.9	76
90	3-1/2"	101.6	89
100	4"	114.3	102
125	5"	141.3	127
150	6"	168.3	152
200	8"	219.1	203
250	10"	273	254
300	12"	323.8	305
350	14"	355.6	355.6
400	16"	406.4	406.4
450	18"	457	457
500	20"	508	508
550	22"	559	559
600	24"	610	610

Note:

•All dimensions are in millimeters

SPECIFICATION

**Short Radius Elbows(180°)**

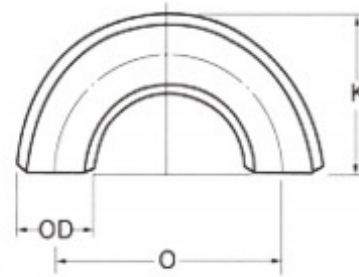

ASME/ANSI B16.28

Nominal Pipe Size		Outside Diameter at Bevel, OD	Center-to-Center	Back-to-Face
DN	NPS		O	K
25	1"	33.4	51	41
32	1-1/4"	42.2	64	52
40	1-1/2"	48.3	76	62
50	2"	60.3	102	81
65	2-1/2"	73	127	100
80	3"	88.9	152	121
90	3-1/2"	101.6	178	140
100	4"	114.3	178	159
125	5"	141.3	254	197
150	6"	168.3	305	237
200	8"	219.1	406	313
250	10"	273	508	391
300	12"	323.8	610	467
350	14"	355.6	711	533
400	16"	406.4	813	610
450	18"	457	914	686
500	20"	508	1016	762
550	22"	559	1118	838
600	24"	610	1219	914

Note:

•All dimensions are in millimeters