

SPECIFICATION

Branch Outlet-Socket Welding

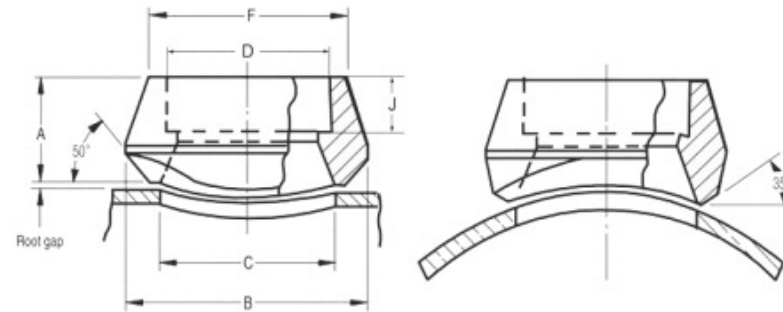

MSS SP-97/CLASS 3000

Nominal Pipe Size		A	B	C	D	F	J(Min)
DN	NPS						
6	1/8"	19	25.4	13.7	10.9	17.3	10
8	1/4"	19	25.4	13.7	14.4	22	10
10	3/8"	21	31.8	17.1	17.8	25.8	10
15	1/2"	25	34.9	21.3	22	31.3	10
20	3/4"	27	44.5	26.7	27.3	37.1	13
25	1"	33	54	33.4	34.1	45.5	13
32	1-1/4"	33	65.1	42.2	42.8	54.9	13
40	1-1/2"	35	73	48.3	48.9	61.6	13
50	2"	38	88.9	60.3	61.4	75.3	16
65	2-1/2"	46	103.2	73	74.2	91.7	16
80	3"	51	122.2	88.9	90.1	109.1	16
100	4"	57	152.4	114.3	115.8	137.2	16

Note:

•All dimensions are in millimeters

SPECIFICATION

Branch Outlet-Threaded

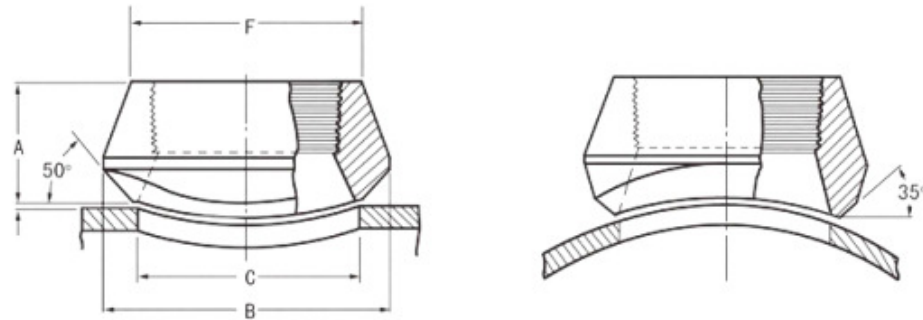

MSS SP-97/CLASS 3000

Nominal Pipe Size		A	B	C	F
DN	NPS				
6	1/8"	19	25.4	15.9	17.3
8	1/4"	19	25.4	15.9	22
10	3/8"	21	31.8	19.1	25.8
15	1/2"	25	34.9	23.8	31.3
20	3/4"	27	44.5	30.2	37.1
25	1"	33	54	36.5	45.5
32	1-1/4"	33	65.1	44.5	54.9
40	1-1/2"	35	73	50.8	61.6
50	2"	38	88.9	65.1	75.3
65	2-1/2"	46	103.2	76.2	91.7
80	3"	51	122.2	93.7	109.1
100	4"	57	152.4	120.7	137.2

Note:

•All dimensions are in millimeters

SPECIFICATION

Branch Outlet-Butt-welding

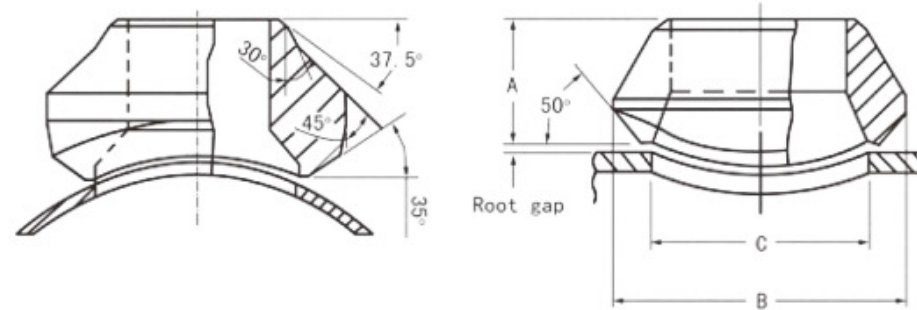

MSS SP-97/STD

Nominal Pipe Size		Face of Fitting to Crotch, A	B	C
DN	NPS			
6	1/8"	16	25.4	15.9
8	1/4"	16	25.4	15.9
10	3/8"	19	31.8	19.1
15	1/2"	19	34.9	23.8
20	3/4"	22	44.5	30.2
25	1"	27	54	36.5
32	1-1/4"	32	65.1	44.5
40	1-1/2"	33	73	50.8
50	2"	38	88.9	65.1
65	2-1/2"	41	103.2	76.2
80	3"	44	122.2	93.7
90	3-1/2"	48	142.9	112.7
100	4"	51	152.4	120.7
125	5"	57	179.4	141.3
150	6"	60	215.9	169.9
200	8"	70	263.5	220.7
250	10"	78	322.3	274.6
300	12"	86	368.3	325.4

SPECIFICATION

Branch Outlet-Butt-welding

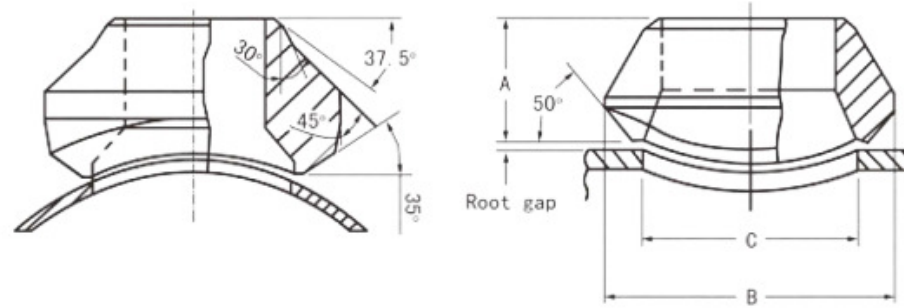

MSS SP-97/STD

Nominal Pipe Size		Face of Fitting to Crotch, A	B	C
DN	NPS			
350	14"	89	409.6	357.2
400	16"	94	457.6	408
450	18"	97	520.7	458.8
500	20"	102	571.5	508
600	24"	116	689	614.4

Note:

•All dimensions are in millimeters