

SPECIFICATION

Socket-Welding Unions

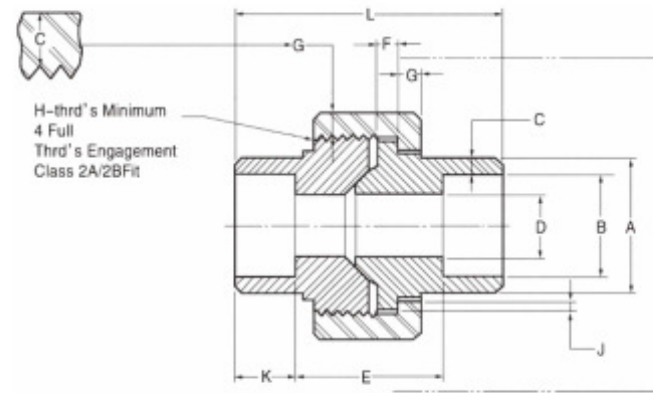

MSS SP-83/CLASS 3000

Nominal Pipe Size		Pipe End Min.,A	Socket Bore Dia.,B		Socket Wall Min.,C	Water Way Bore,D		Laying Length,E		Male Flange Min.,F	Nut Min.,G	Thrds Per Inch,H	Bearing Min.,J	Depth of Socket Min.,K	Length Assem. Nominal,L	Clear Assem Nut,N
DN	NPS		Max.	Min.		Max.	Min.	Max.	Min.							
6	1/8"	21.8	11.18	10.67	3.18	7.59	6.07	22.4	19.1	3.18	3.18	16	1.24	9.7	41.4	50.8
8	1/4"	21.8	14.61	14.1	3.3	10.01	8.48	22.4	19.1	3.18	3.18	16	1.24	9.7	41.4	50.8
10	3/8"	25.9	18.03	17.53	3.51	13.28	11.76	26.9	20.6	3.43	3.43	14	1.37	9.7	46	55.9
15	1/2"	31.2	22.23	21.73	4.09	16.56	15.04	26.9	20.6	3.68	3.68	14	1.5	9.7	49	58.4
20	3/4"	37.1	27.56	27.05	4.27	21.69	20.17	31.8	25.4	4.06	4.06	11	1.68	12.7	56.9	66
25	1"	45.5	34.29	33.78	4.98	27.41	25.88	34.3	26.2	4.57	4.45	11	1.85	12.7	62	78.7
32	1-1/4"	54.9	43.05	42.55	5.28	35.81	34.29	40.6	32.5	5.33	5.21	11	2.13	12.7	71.1	94
40	1-1/2"	61.5	49.15	48.64	5.54	41.66	40.13	42.2	34	5.84	5.59	10	2.31	12.7	76.5	111.8
50	2"	75.2	61.62	61.11	6.05	53.26	51.74	45.5	37.3	6.6	6.35	10	2.69	15.7	86.1	132.1
65	2-1/2"	91.7	74.45	73.81	7.67	64.24	61.19	61.7	52.1	7.49	7.11	8	3.07	15.7	102.4	149.9
80	3"	109.2	90.42	89.79	8.31	79.45	76.4	63.8	53.6	8.26	8	8	3.53	15.7	109	175.3

Note:

•All dimensions are in millimeters

SPECIFICATION

Threaded Fittings Unions

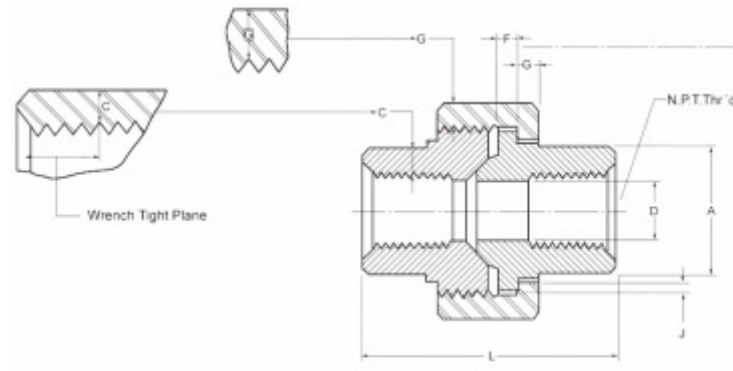

MSS SP-83/CLASS 3000

Nominal Pipe Size		Pipe End Min.,A	Wall Min.,C	Water Way Bore,D		Male Flange Min.,F	Nut Min.,G	Threads Per Inch.,H	Bearing Min.,J	Length Assem. Nominal,L	Clear Assem. Nut,N
DN	NPS			Max.	Min.						
6	1/8"	14.7	2.41	8.43	6.43	3.18	3.18	16	1.24	41.4	50.8
8	1/4"	19	3.02	11.13	9.45	3.18	3.18	16	1.24	41.4	50.8
10	3/8"	22.9	3.2	14.27	13.51	3.43	3.43	14	1.37	46	55.9
15	1/2"	27.7	3.73	17.86	17.07	3.68	3.68	14	1.5	49	58.4
20	3/4"	33.5	3.91	23.01	21.39	4.06	4.06	11	1.68	56.9	66
25	1"	41.4	4.55	28.98	27.74	4.57	4.45	11	1.85	62	78.7
32	1-1/4"	50.5	4.85	37.69	35.36	5.33	5.21	11	2.13	71.1	94
40	1-1/2"	57.2	5.08	43.54	41.2	5.84	5.59	10	2.31	76.5	111.8
50	2"	70.1	5.54	55.58	52.12	6.6	6.35	10	2.69	86.1	132.1
65	2-1/2"	85.3	7.01	66.27	64.31	7.49	7.11	8	3.07	102.4	149.9
80	3"	102.4	7.62	88.25	77.27	8.26	8	8	3.53	109	175.3

Note:

•All dimensions are in millimeters